

! Please observe all safety instructions in the operating manual!
! This document is only intended as an aid and does not replace reading the operating manual. **!**

Step 1

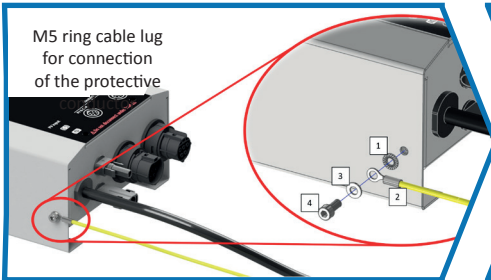

Check grounding

Step 2

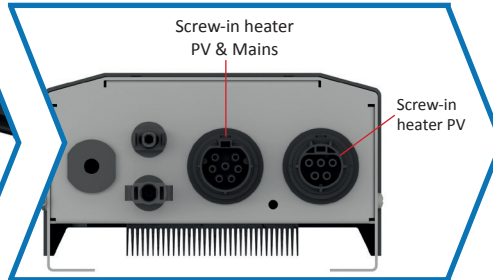

Connect the heating elements

Step 3

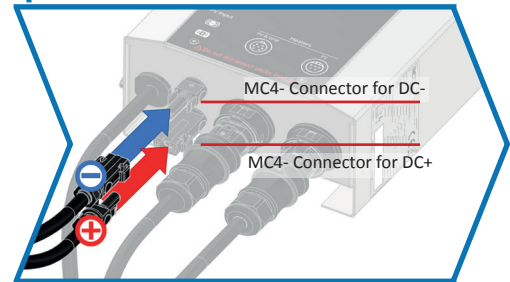

Connect mains & PV with the ENC
 (PV modules should be connected in series)

Step 4: Configure ENC

Boiler booting...

Always disable the boiler in the settings, before disconnecting the connectors!

Setup

Confirm once all connectors are properly plugged in.

Do not disconnect anything under load.

Setup 1 2

How many heaters are installed in your device?

For help refer to the setup guide in the manual.

After connecting the ENC with power sources, the booting process starts. Control of the ENC is done via touch display.

Are all connectors connected correctly? Click on the check mark to confirm.

Choose product type:
 1 - NEX R1 screw-in heater is connect
 2 - NEX R2 screw-in heaters are connected

NEX-R1

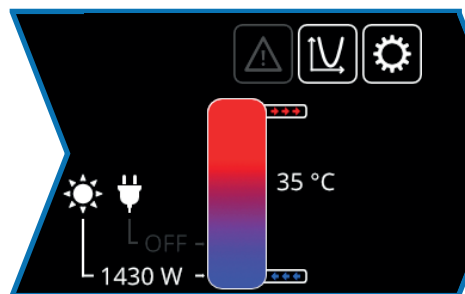

Display main page
 For detailed explanation, see p. 33 of the operating instructions.

NEOL
 Calibration
 Calibration of the heaters is in progress ...
 Please wait until the calibration is completed.
 This may take some time.

As soon as >500W are applied over a longer period of time, temperature sensors and control are adjusted to the installation.

NEX-R2

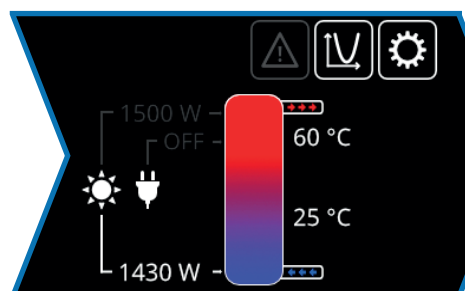

NEOL
 Calibration
 Calibration of the heaters is in progress ...
 Please wait until the calibration is completed.
 This may take some time.

DEFAULT SETTINGS

NEX R1/ NEX R2

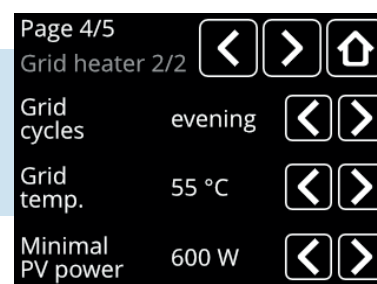
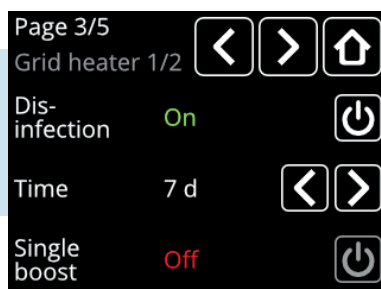
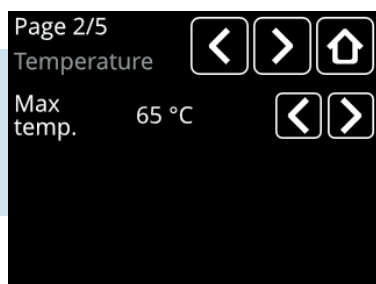

		NEX-R1	NEX-R2	To be found in the operating instructions
Maximum Temp. Page 2/5	What is the maximum temperature that can be reached with solar power?	60°C	60°C	p. 35
Disinfection Page 3/5	Is the legionella protection program activated?	On (active)	On (active)	p. 38
Time Page 3/5	At what interval is the legionella program applied?	7 d (days)	7 d (days)	p. 38
Single boost Seite 3/5	At what PV power does the ENC start reheating?	Inactive	Inactive	p. 38
Grid cycles Page 4/5	Is the storage tank reheated? If yes, how often per day?	evening	e+2	p. 36
Grid temp. Page 4/5	Which target temperature is reached with the mains current?	45°C	55°C	p. 37
Minimal PV power Page 4/5	Is it activated that the storage heats up immediately with the maximum power (grid & PV) to 65°C?	300W	600W	p. 37

The explanation of the error codes can be found on page 42 in the operating instructions